



200 Series NGV1 P30/P36 Fueling Nozzle

Applications

Refuelling and dispensing nozzle for CNG and Bio-Gas applications such as car & bus filling.



P30 & P36 NGV1 Nozzles

Features & Benefits

Hardened segment connection style increases gripping surface area. This significantly reduces wear on male coupling.

Stainless steel construction gives corrosion and wear resistance.

P30 (3000PSI) & P36 (3600PSI) nozzles available.

Green indicator shows coupled position.

Product Information

All products are manufactured under ISO 9001 accredited standards.

Class A tested to 100,000 cycles.

Compatible with receptacles designed to ANSI/CSA NGV1 Standard.

Complies to PED 2014/68/EU.

CRN (0A23666.5C) approved for all provinces

Materials

Item	Part	Material
1	Body	316 Stainless Steel
2	Coupler Nose	316 Stainless Steel
3	Poppet	316 Stainless Steel
4	O-rings	Nitrile
5	End Cap	316 Stainless Steel
6	Segments	420 Stainless Steel
7	Ball Bearings	316 Stainless Steel



200 Series NGV1 P30/P36 Fueling Nozzle

Dimensions

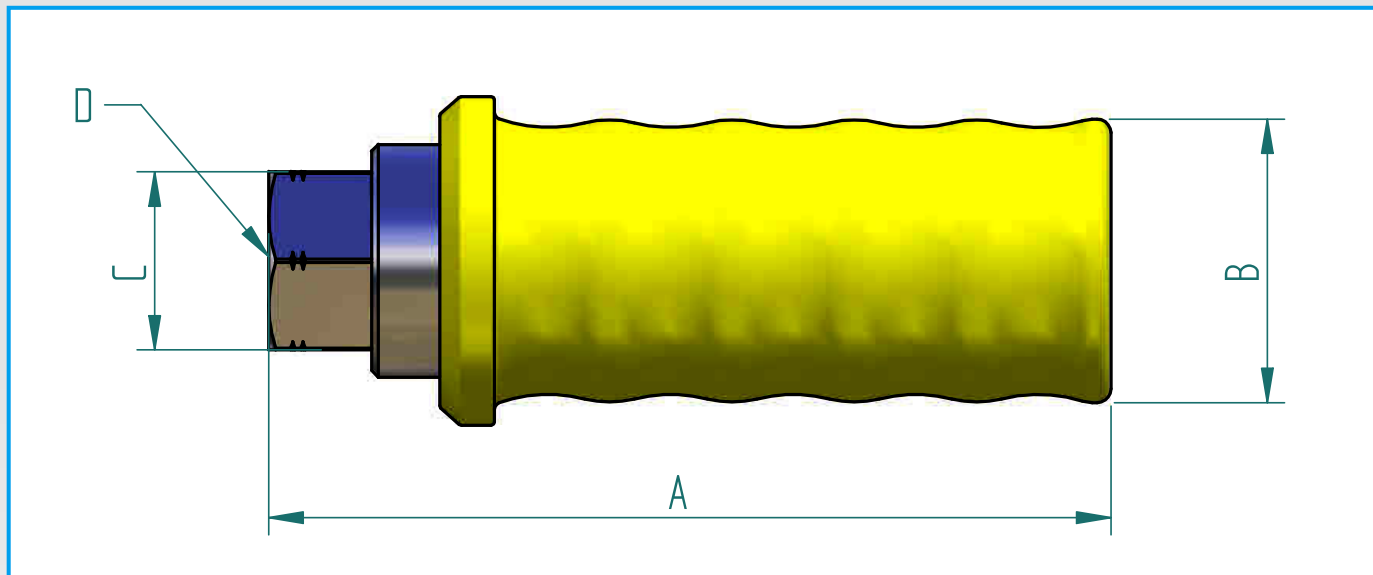

Dimensions: Imperial (mm)

Part Code	Size	A	B	C (A/F)	D (Inlet Port)	Handle Sleeve Color
NC203-P30	3/8"	4.84" (122.9)	1.63" (41.4)	1.02" (26)	9/16 - 18 SAE	Blue
NC203-P36	3/8"	4.84" (122.9)	1.63" (41.4)	1.02" (26)	9/16 - 18 SAE	Yellow

Product Specification

Part Code	Mass lb (kg)	Service Pressure bar (psi) *	MAWP bar (psi)**	Min. Temp. °F (°C)	Max. Temp. °F (°C)	Cycles Before Rekit ^	Cv	Nozzle Service Kit
NC203-P30	1.43 (0.65)	206 (3000)	312.5 (4532)	-40 (40)	185 (85)	100,000	2.2	NC203-SK1
NC203-P36	1.43 (0.65)	248 (3600)	312.5 (4532)	-40 (40)	185 (85)	100,000	2.2	NC203-SK1

* System pressure that the product is designed for.

** Maximum Allowable Working Pressure, the maximum static pressure that can be applied without affecting the operation of the product.

^ It is recommended that the nozzle is re-kitted on or before the maximum number of allowable cycles.