



Brass Swivel Unions

Applications

These brass swivels are suitable in low-pressure applications, hose reels, fuel nozzles, pump to hose connections and hot bitumen lines.



Brass Swivels

Materials

Item	Description	Material
1	Body	Brass
2	Seal	Urethane
3	O-Ring	Viton
4	Ball	Stainless Steel

Features & Benefits

Designed for low pressure applications, these swivels are highly customisable.

Standard end connections can be replaced with tube weld, swaged hose tail or different standardized thread options.

Product Information

All products manufactured under ISO9001 standards.

BSPP Female & BSPT Male thread is standard quoted option.



Brass Swivel Unions

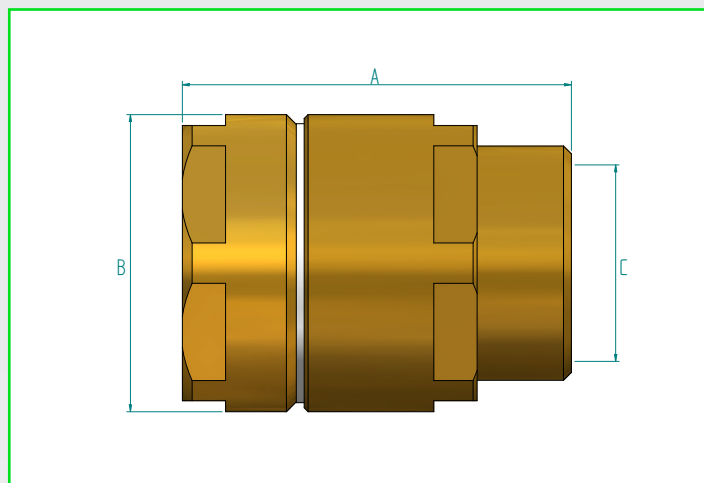

Dimensions (mm)

Part Code	Size	A	B	C	Standard Thread
BSU020-BT-MF**	3/4"	55	38	19	3/4" BSP
BSU025-BT-MF**	1"	61	47	25	1" BSP
BSU032-BT-MF	1 1/4"	60	53	31	1 1/4" BSP
BSU038-BT-MF	1 1/2"	75	63	37	1 1/2" BSP
BSU050-BT-MF	2"	108	112	50	2" BSP
BSU063-BT-MF	2 1/2"	127	100	63	2 1/2" BSP
BSU076-BT-MF	3"	133	112	76	3" BSP

Product Specification

Part Code	Mass kg (lb)	Min. Temp. °C (°F)	Max. Temp. °C (°F)	Max. Operating Pressure psi (bar) *
BSU020-BT-MF**	0.3 (0.7)	-40 (40)	90 (194)	200 (13)
BSU025-BT-MF**	0.4 (0.9)	-40 (40)	90 (194)	200 (13)
BSU032-BT-MF	0.5 (1.1)	-40 (40)	90 (194)	200 (13)
BSU038-BT-MF	0.8 (1.8)	-40 (40)	90 (194)	200 (13)
BSU050-BT-MF	1.4 (3.1)	-40 (40)	90 (194)	200 (13)
BSU063-BT-MF**	3.4 (7.5)	-40 (40)	90 (194)	200 (13)
BSU076-BT-MF**	4.5 (9.9)	-40 (40)	90 (194)	200 (13)

* Maximum pressure at which the product can constantly operate at.

** Made to order

We reserve the right to modify product specifications without prior notice.