



SNV300 Series

Non Return Valves

Instruction Manual

Oasis Engineering Ltd
129 Birch Avenue, Tauranga, New Zealand.
T: +64 7 928 3808 F: +64 7 928 3809
E: info@oasisNGV.com
W: www.OasisNGV.com

Warning!

Oasis recommends considering the use of the following PPE along with any other site specific health and safety requirements:



Protective Clothing



Welding Mask



Foot Protection



Hearing Protection



Safety Helmets



Hand Protection



Safety Glasses

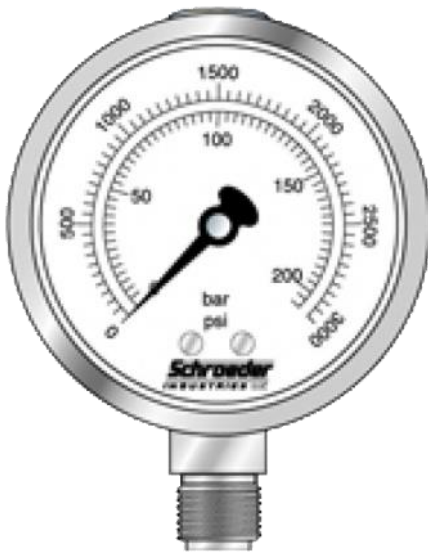

Ensure the system is drained & isolated before any installation or servicing work is carried out.

Tools Required



C Spanner



TIG Welder

1. Unscrew valve and remove poppet.

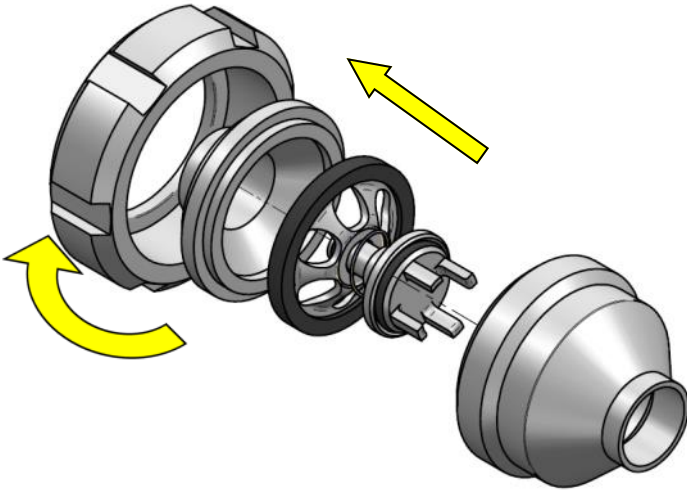

2. Ensure the correct flow direction is considered before welding joint.

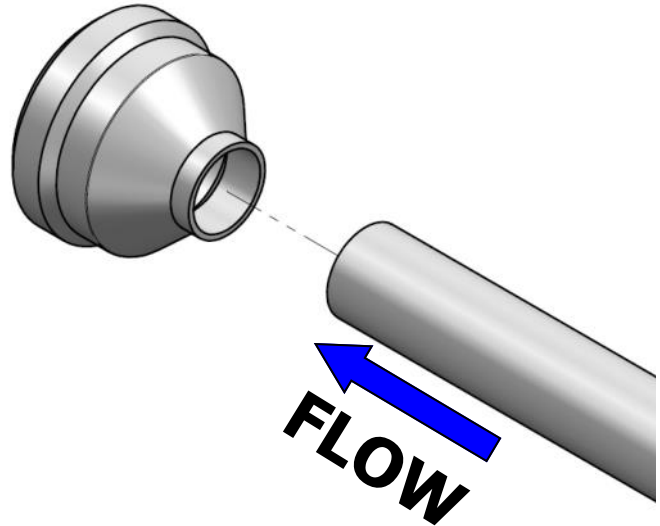

3. Joint is to be welded, connecting the non return valve to the pipe. Polish and clean weld to the required standard.

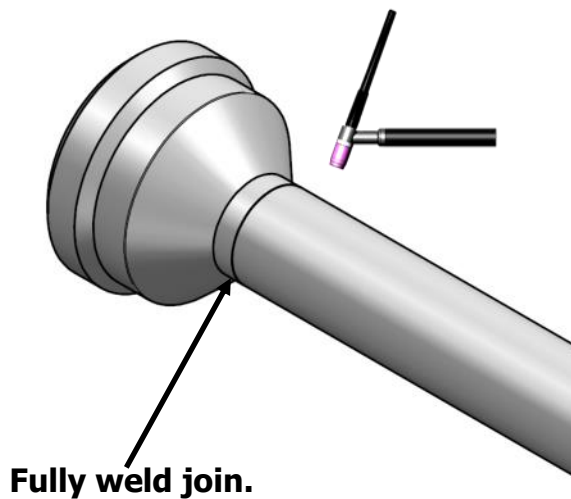

4. Reinstall poppet.

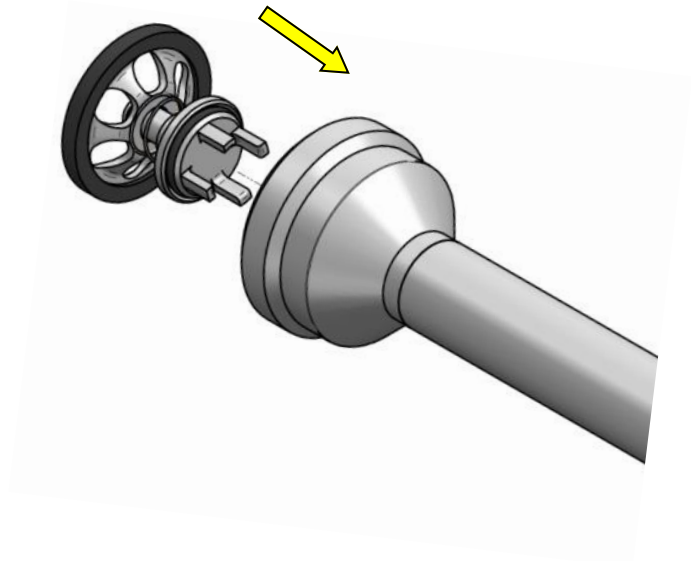

5. Ensure the correct flow direction is considered and nut is in place before welding joint.

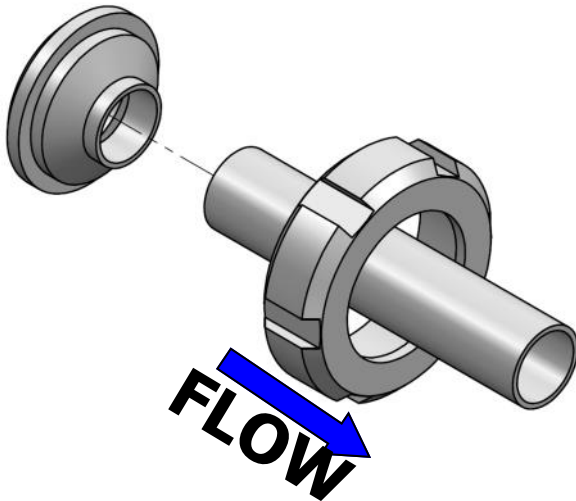

6. Joint is to be welded, connect the non return valve to the pipe. Polish and clean weld to the required standard.

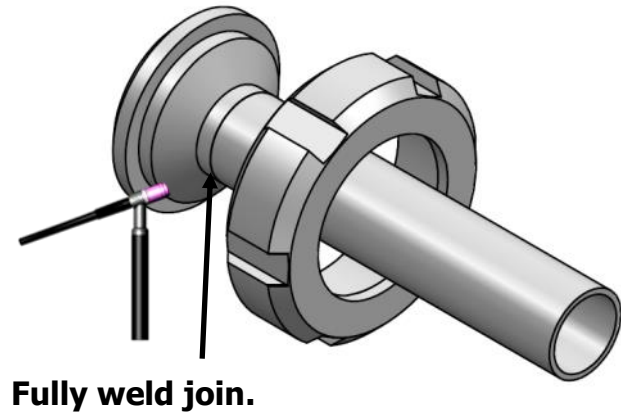

7. Connect the two sides together.

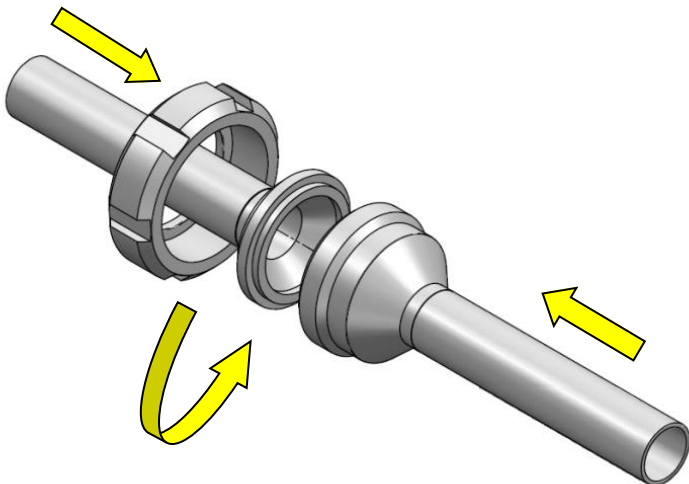

8. Installation complete, check for leaks on first use.

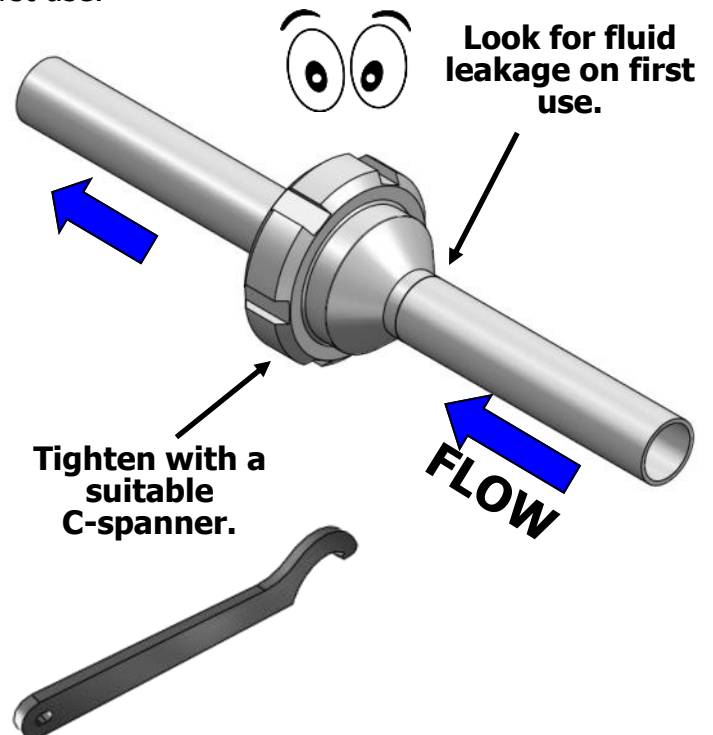

Service Kit Parts

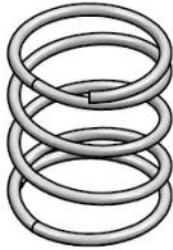

Spring



O-ring



Main Seal



O-ring

The Complete Oasis Seal Kit must be used

Tools Required



Cleaner
(Warm Soapy Water or Similar)



Food Grade Grease
(Omage 58 or Similar)



C Spanner

Exploded View

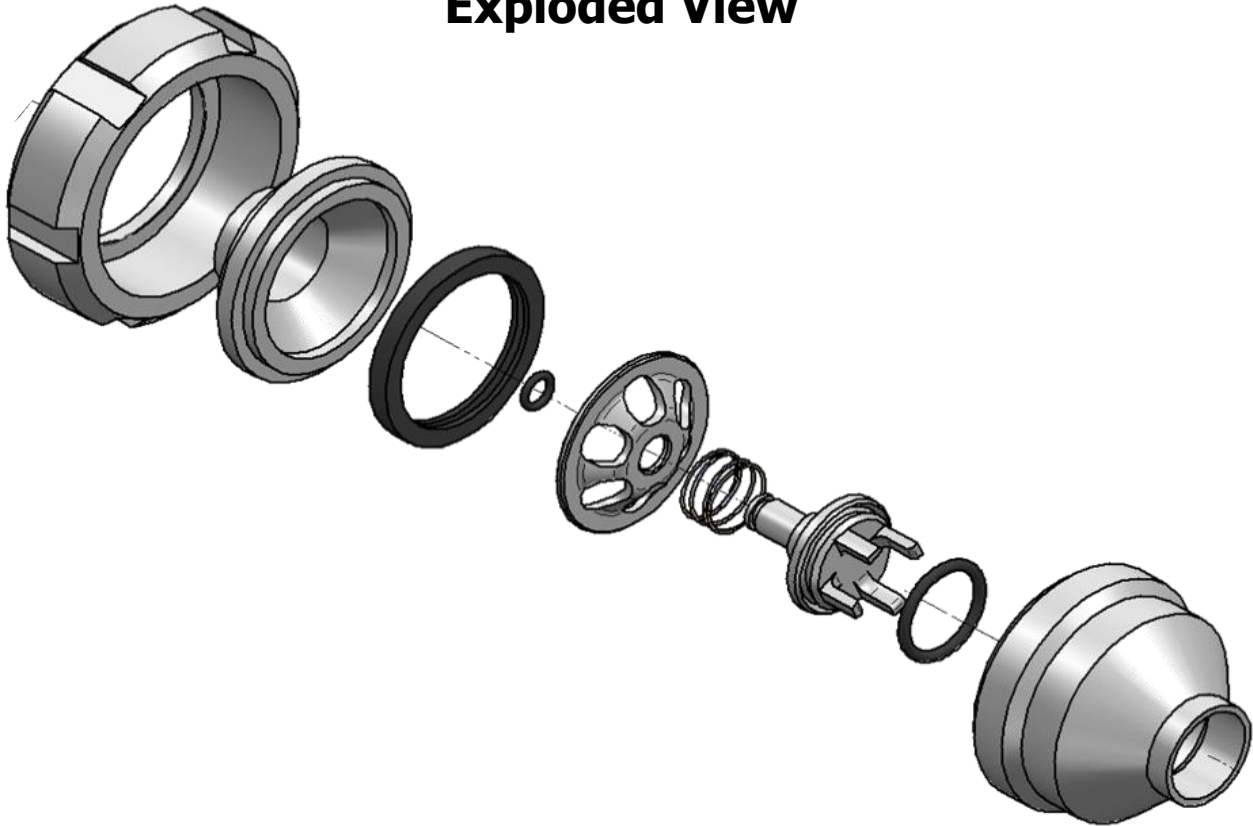

1. Uncouple valve.

2. Remove poppet.

3. Disassemble poppet and discard spring and O-ring.

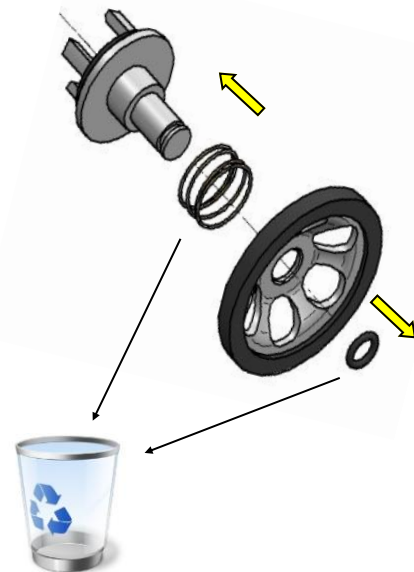
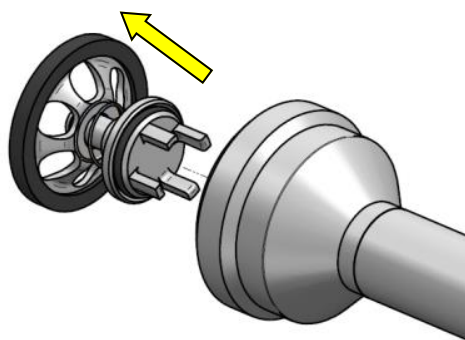
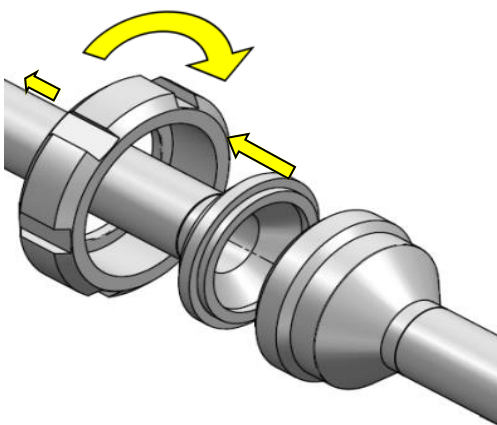

4. Discard seal.

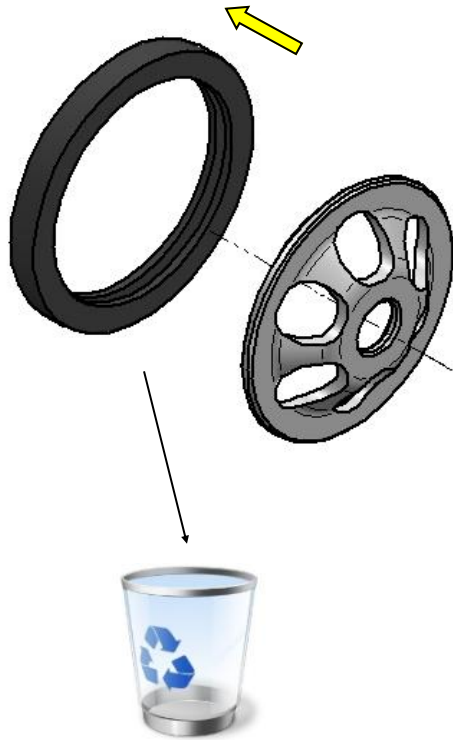

5. Discard O-ring.

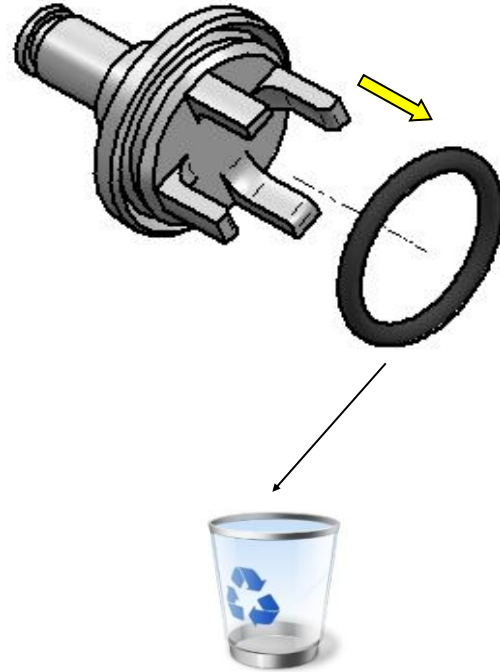

6. Clean components.

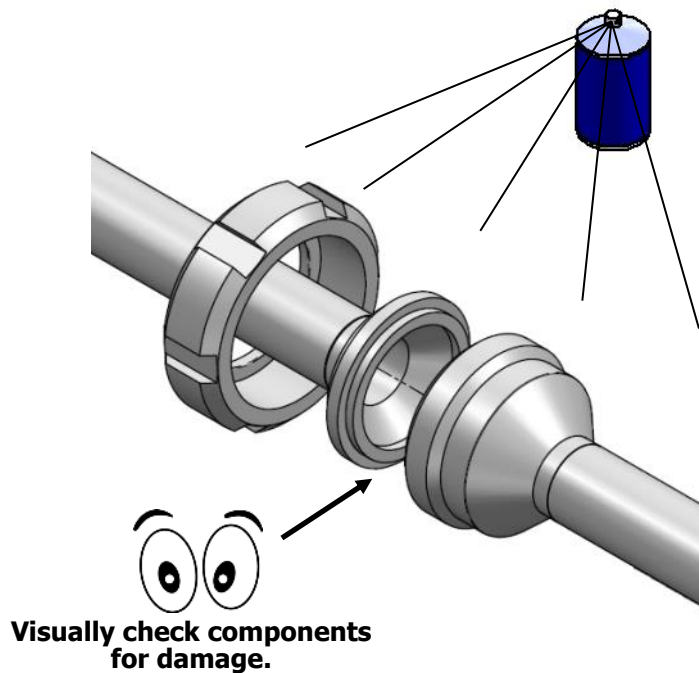

7. Grease O-ring.

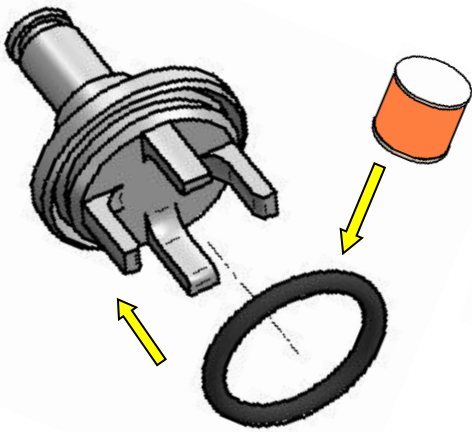

8. Fit new seal.



9. Assemble poppet.

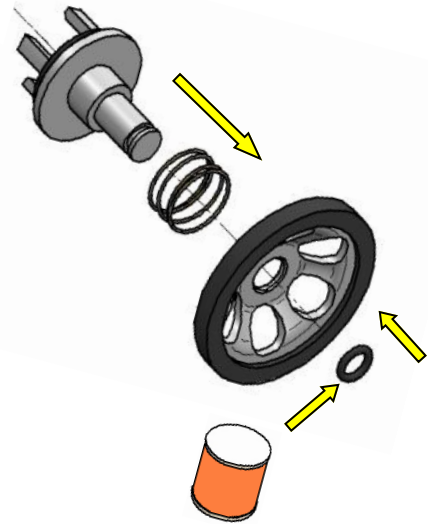

10. Install poppet.

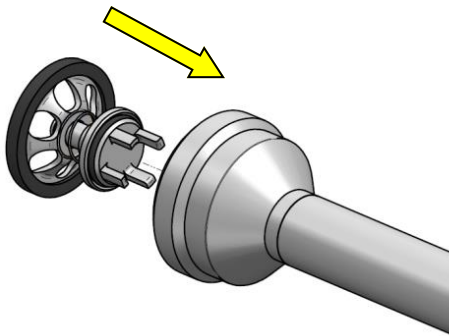

11. Connect valve.

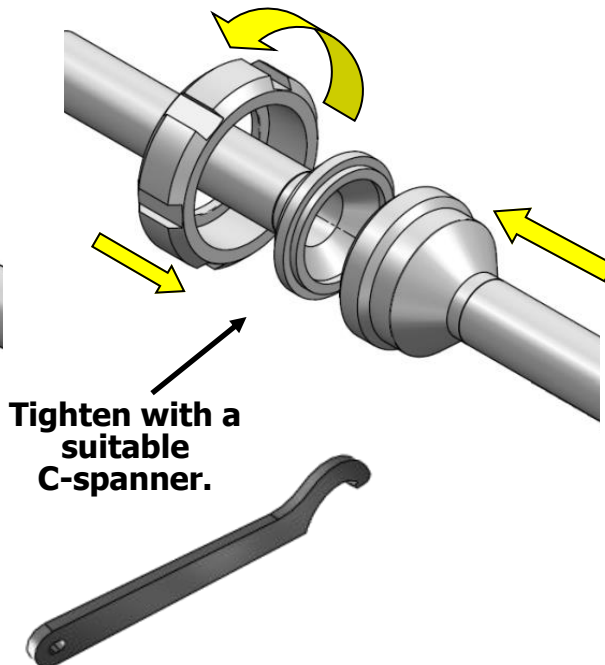

12. Complete.

