

Oasis



PV250-SV2

Vat Inlet Valve with CIP Non Return Valve

Instruction Manual

Oasis Engineering Ltd
129 Birch Avenue, Tauranga, New Zealand.
T: +64 7 928 3808 F: +64 7 928 3809
E: info@oasisNGV.com
W: www.OasisNGV.com

Warning!

Ensure that the pipeline is relieved of all pressure and media before removing or installing a valve. Can cause serious harm to both infrastructure and personnel if safety precautions are not followed.

Oasis recommends considering the use of the following PPE when working with high pressure along with any other site specific health and safety requirements:



Foot Protection



Hearing Protection



Safety Helmets



Hand Protection



Safety Glasses

Tools Required



Food Grade Grease
(FDA approved lubricant)



C Spanner

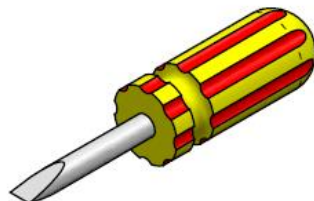

Screw driver
(for hose clamp)

1. Position the valve in the correct position. Install RJT seals, pipe work and RJT nuts. The center port should be connected to the milk vat.

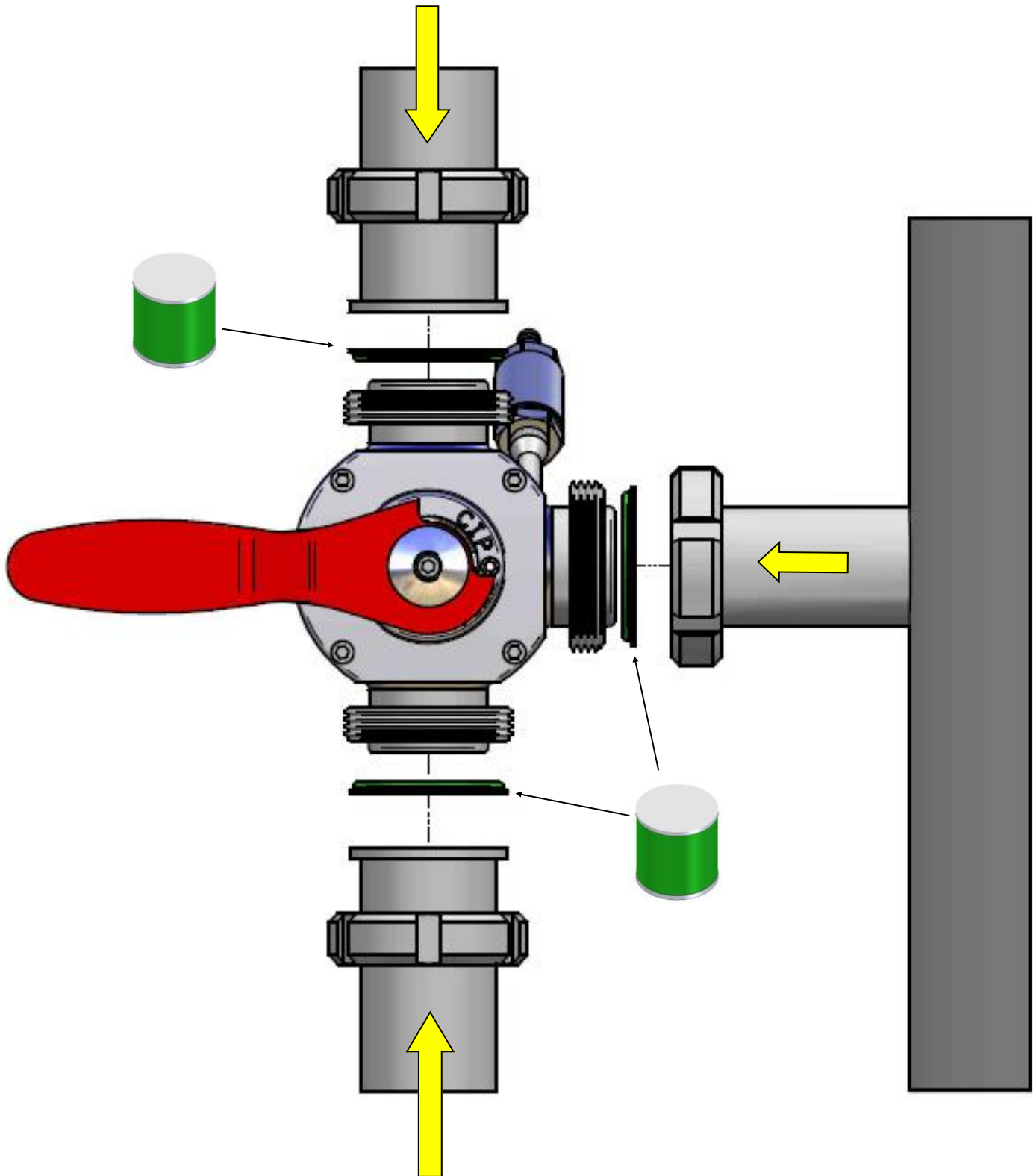

2. Tighten RJT nuts using a C spanner.

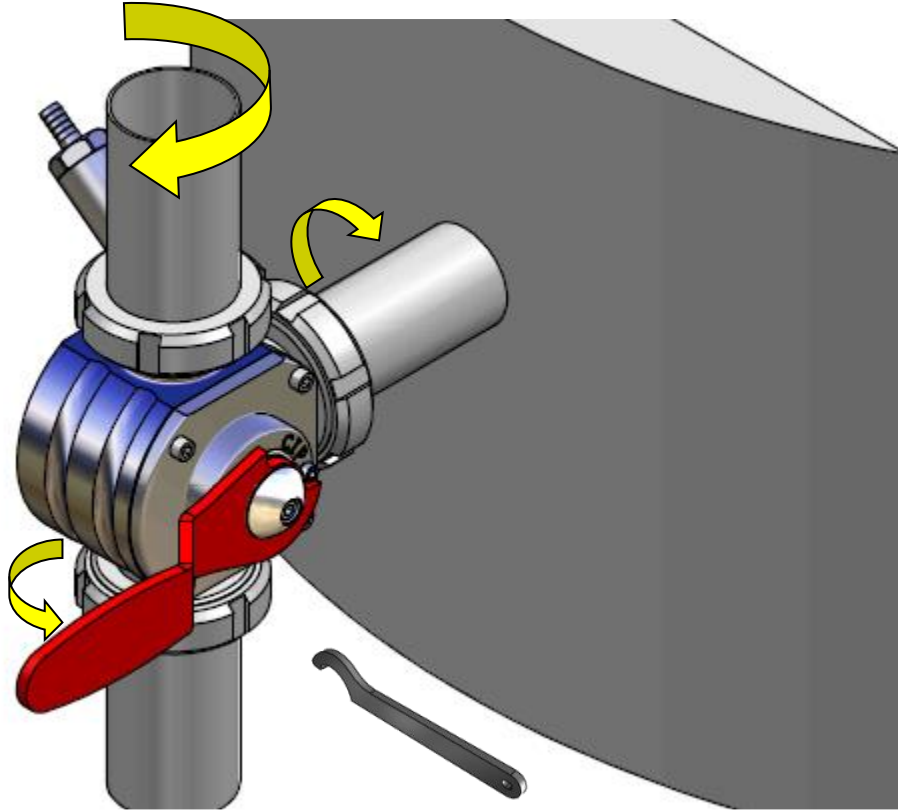

3. Install the CIP cleaning fluid supply and fix with a hose clamp. On first use check for leakage.

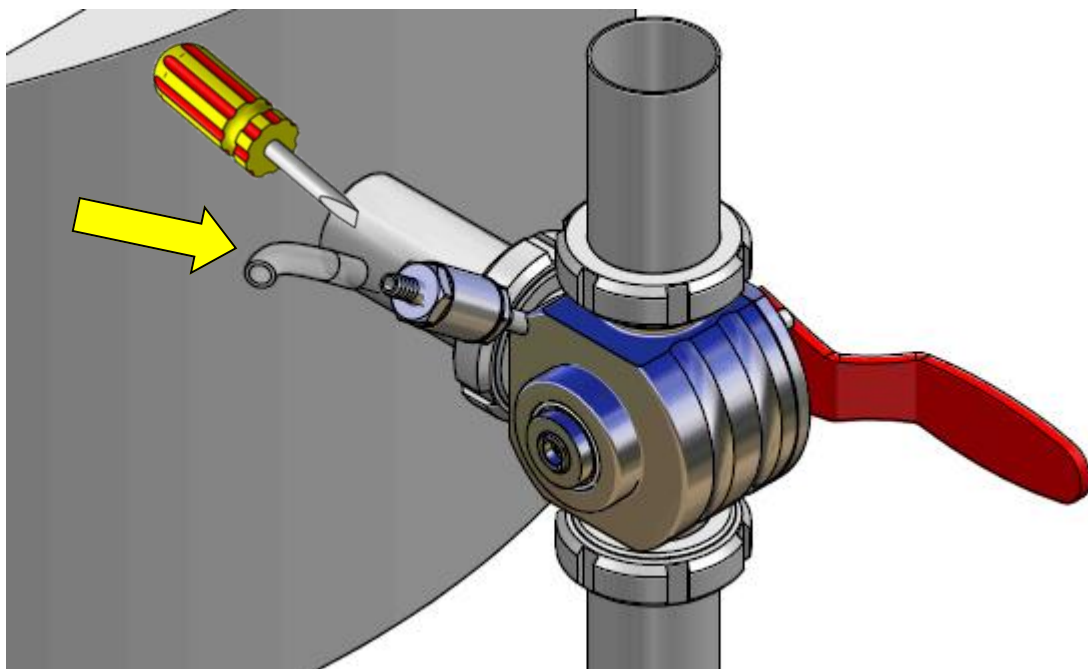

The closed port is always opposite the handle.

Plant Entry to Vat : Handle Vertical

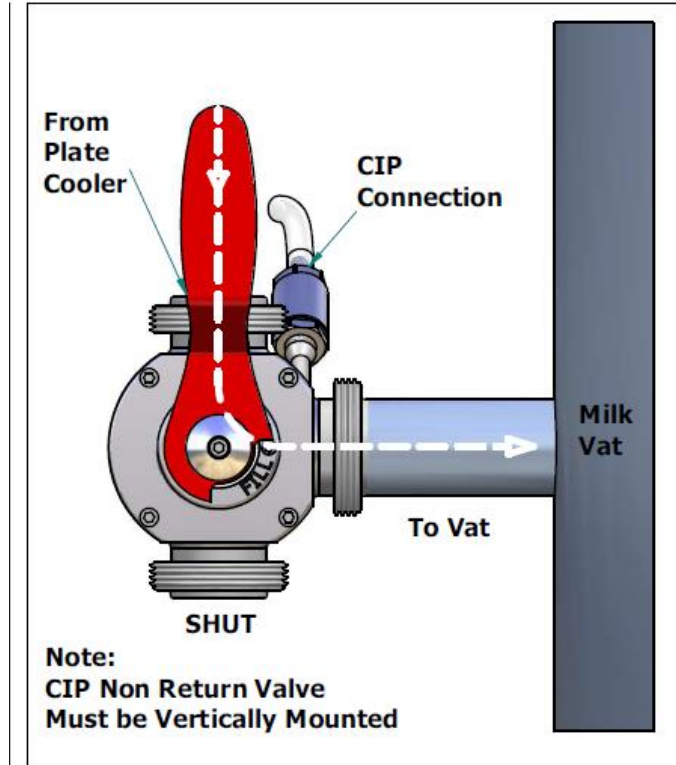

Plant Cleaning : Handle Horizontal

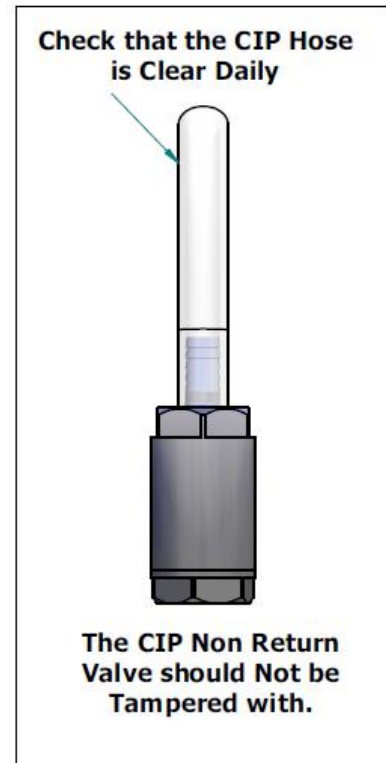
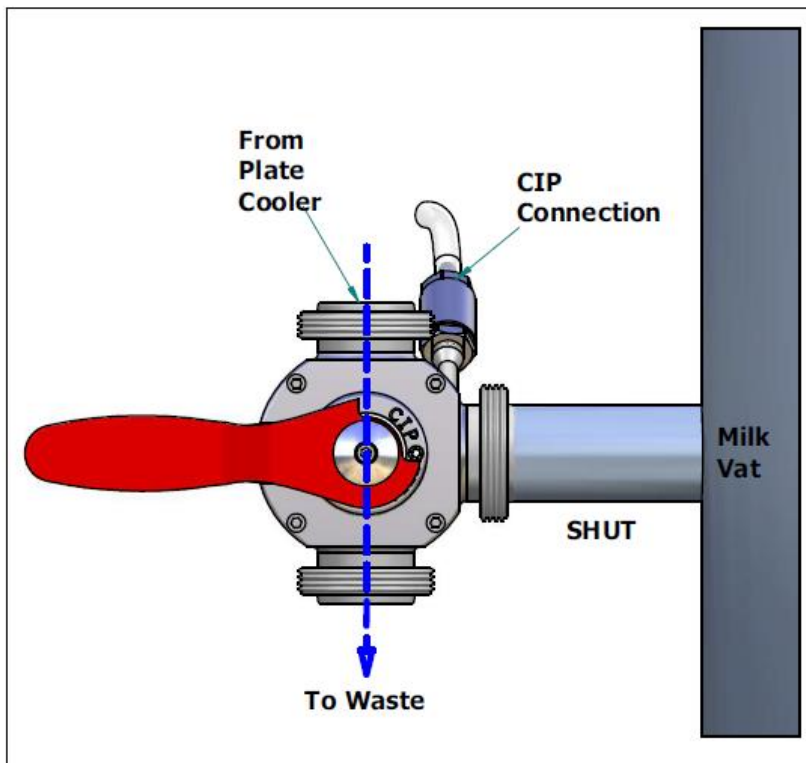

Service Kit Parts



BUSH x2



PLUG



GLAND



CAP O-RING x1



SPINDLE O-RING x2



PLUG O-RING



GLAND O-RING

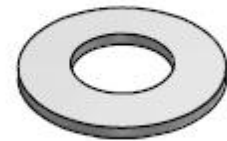

BELLEVILLE WASHERS x3

The Complete Oasis Seal Kit must be used

Tools Required



Food Grade Cleaner (FDA approved lubricant) (Warm Soapy Water or Similar)

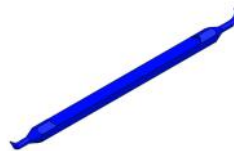

Pick Tool Part Number: TOOL-PICK (Sold separately)



Food Grade Anti Seize

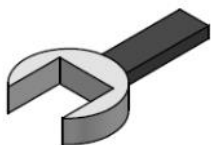

Spanner (Wrenches)

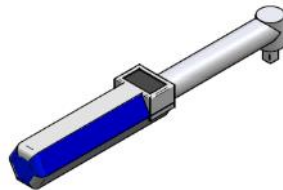

Torque Wrench

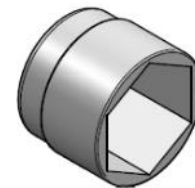

Sockets



Food Grade Grease (FDA approved lubricant)

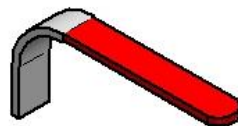

Lock Nut Tool



Allen Keys 10mm 5mm 4mm



Copper or Plastic Hammer



Pliers

1. Remove valve from vat and use lock nut tool to loosen lock nut.

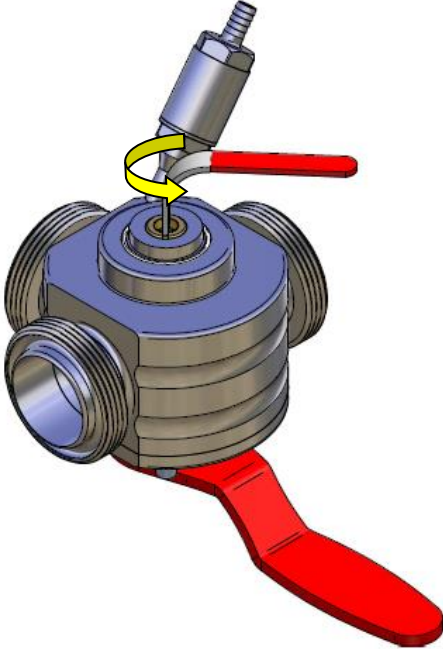

2. Remove the lock nut.

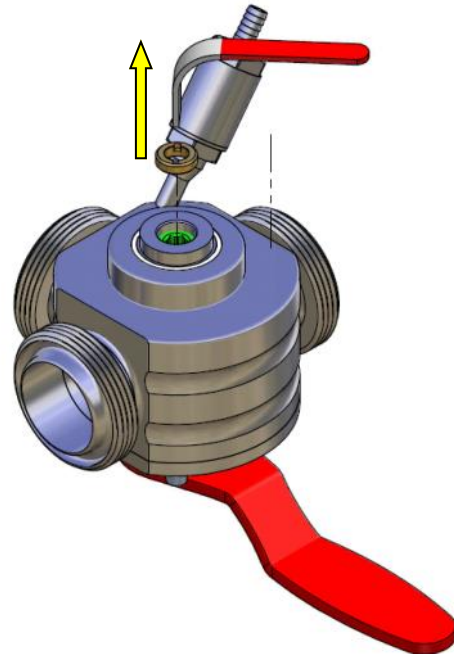

3. Loosen wedge nut with a 10mm Allen key (3-4 turns).

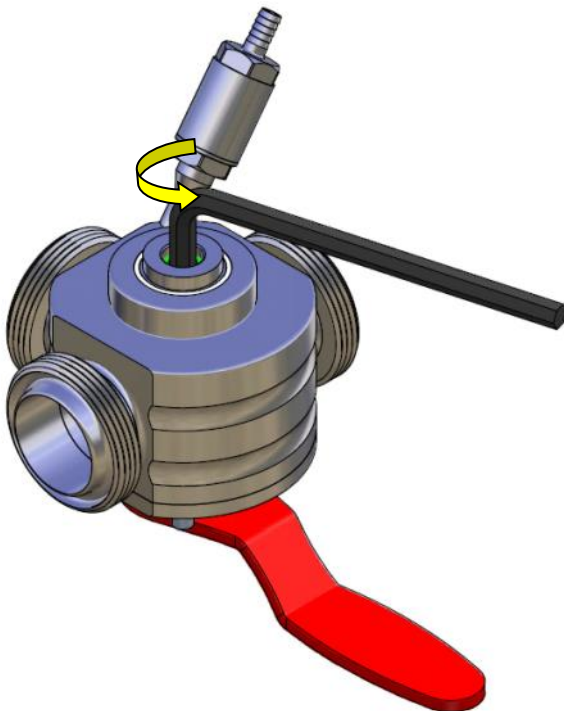

4. Remove the handle using a 5mm Allen key.

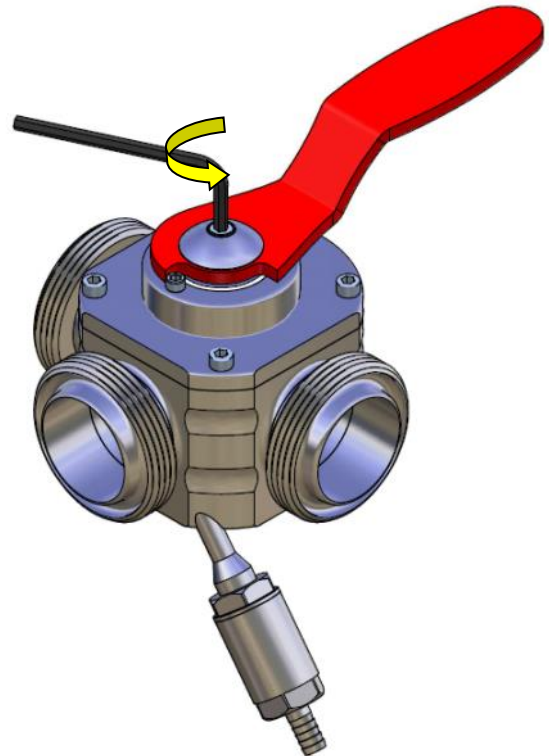

5. Pull handle off.

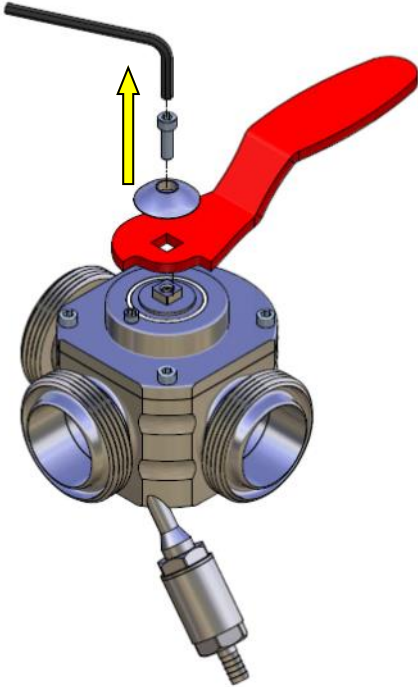

6. Loosen end cap bolts.

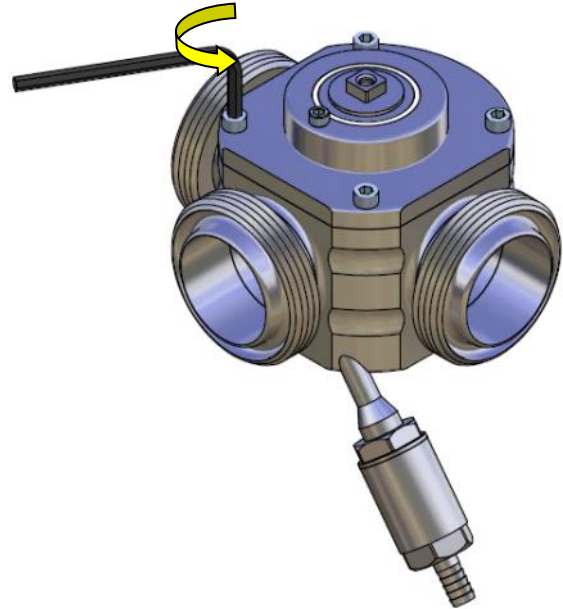

7. Remove end cap.

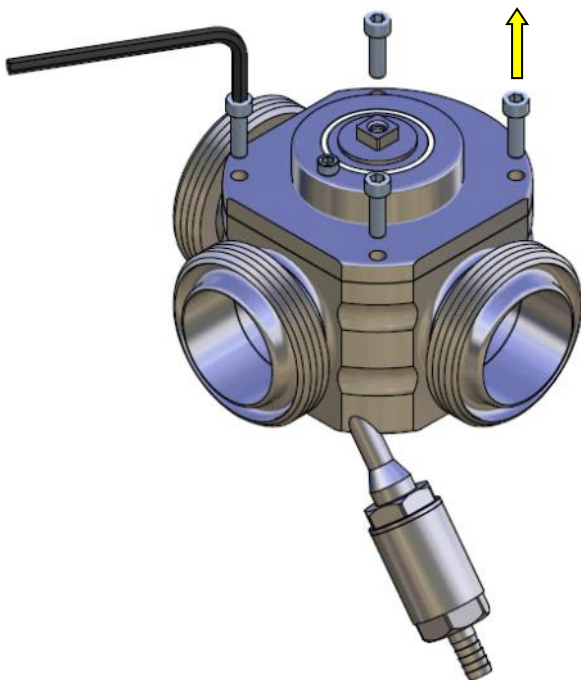

8. It maybe required to use a soft hammer to tap the spindle through the cap.

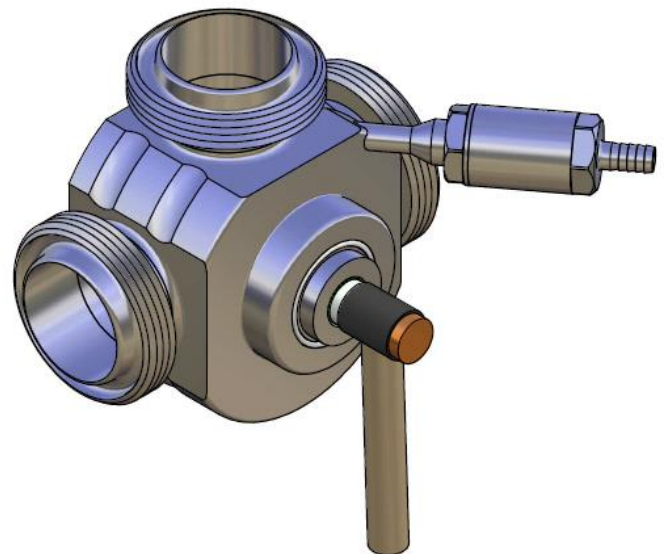

9. Pull out the spindle and separate it from the cap. Discard cap O-ring.

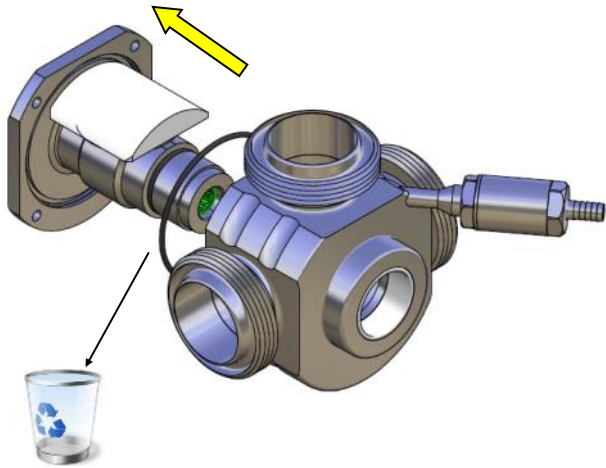

10. Use a screw driver (or punch) and hammer to tap out the bush in the cap.

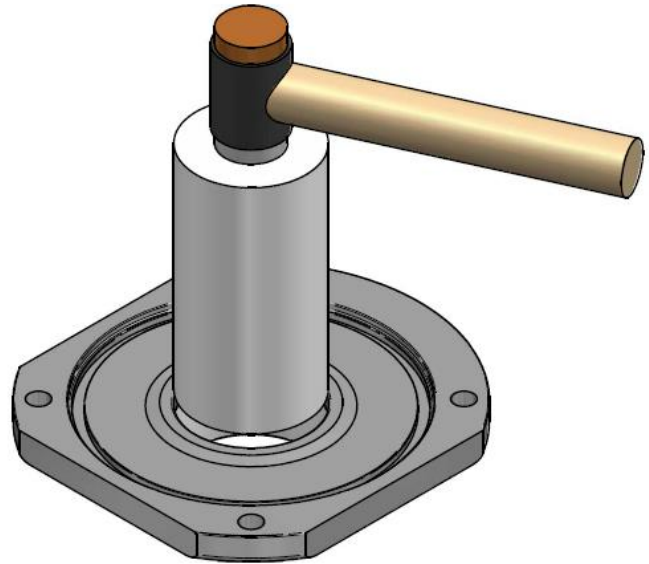

**TAKE CARE TO NOT
SCRATCH THE BODY**

11. Use a screw driver (or punch) and hammer to tap out the bush in the body.

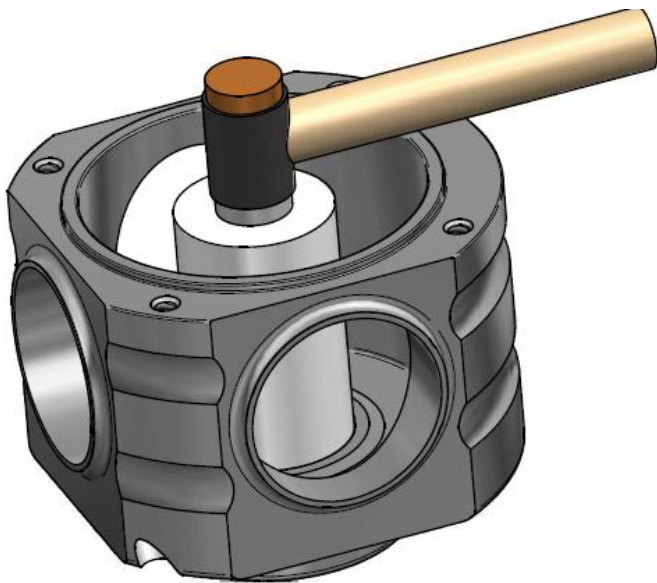

**TAKE CARE TO NOT
SCRATCH THE BODY**

12. Remove plug assembly from spindle and discard O-ring and plug.

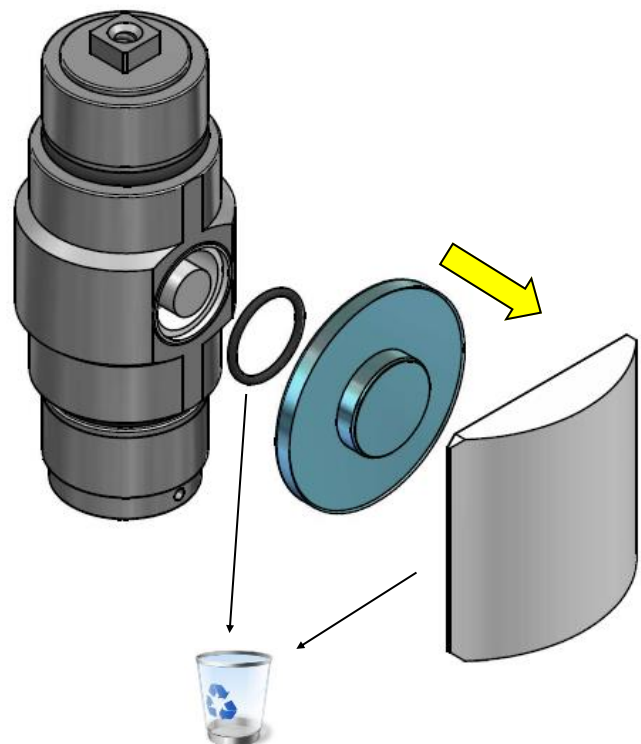

13. Use pliers to remove plug
Shaft.

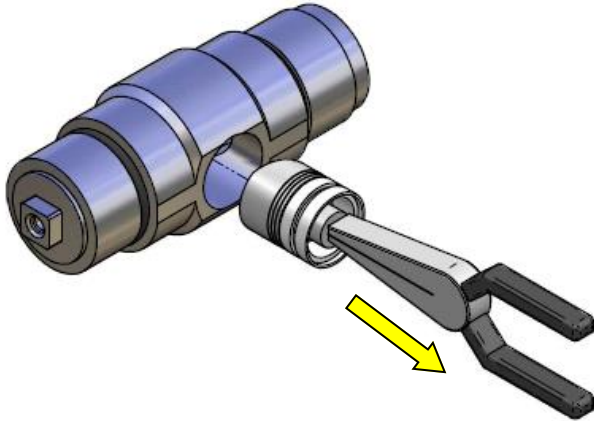

14. Discard gland, O-ring and washers. Do
not throw away shaft.

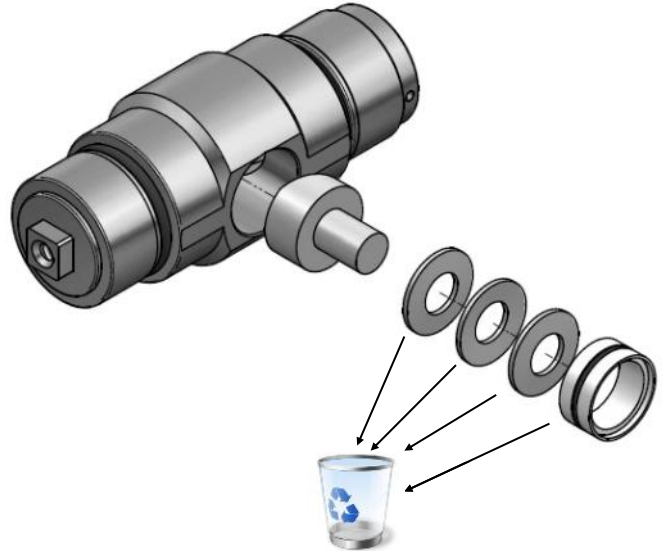

15. Discard spindle O-rings.

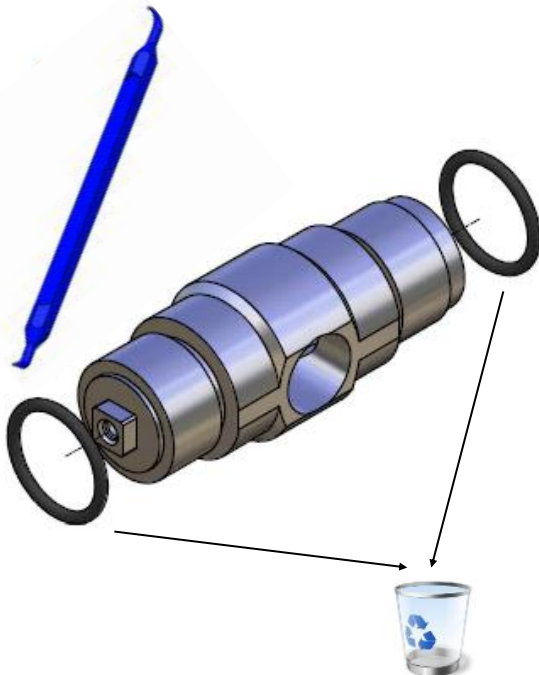

16. Remove adjustment wedge and nut.

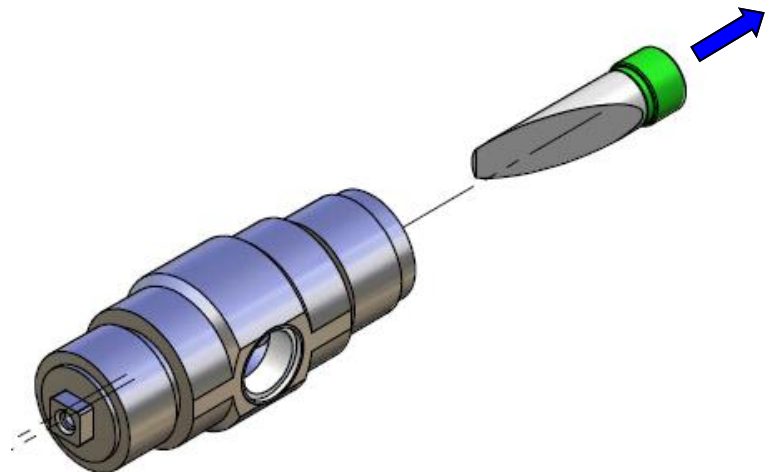

17. If required, remove CIP and follow PV250-CIP servicing instructions.

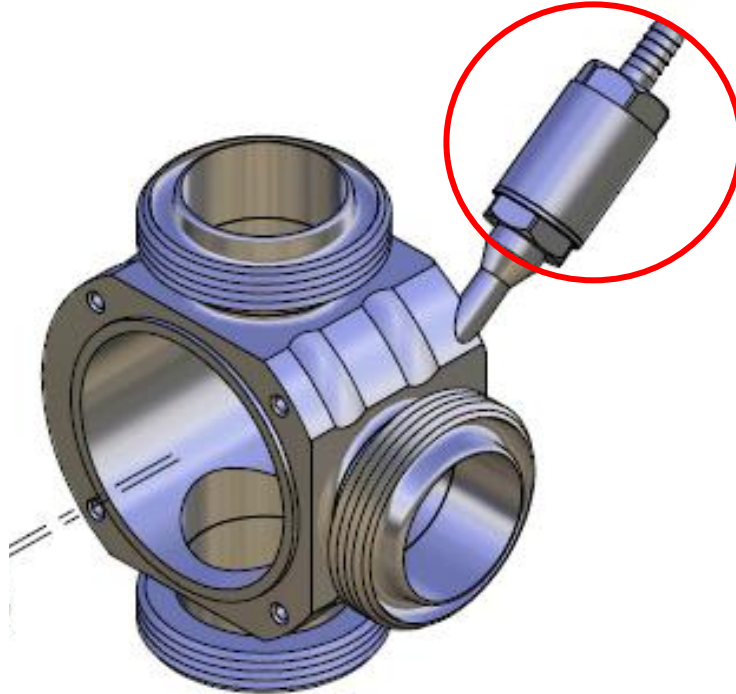

18. Clean all components and ready for re-assembly.

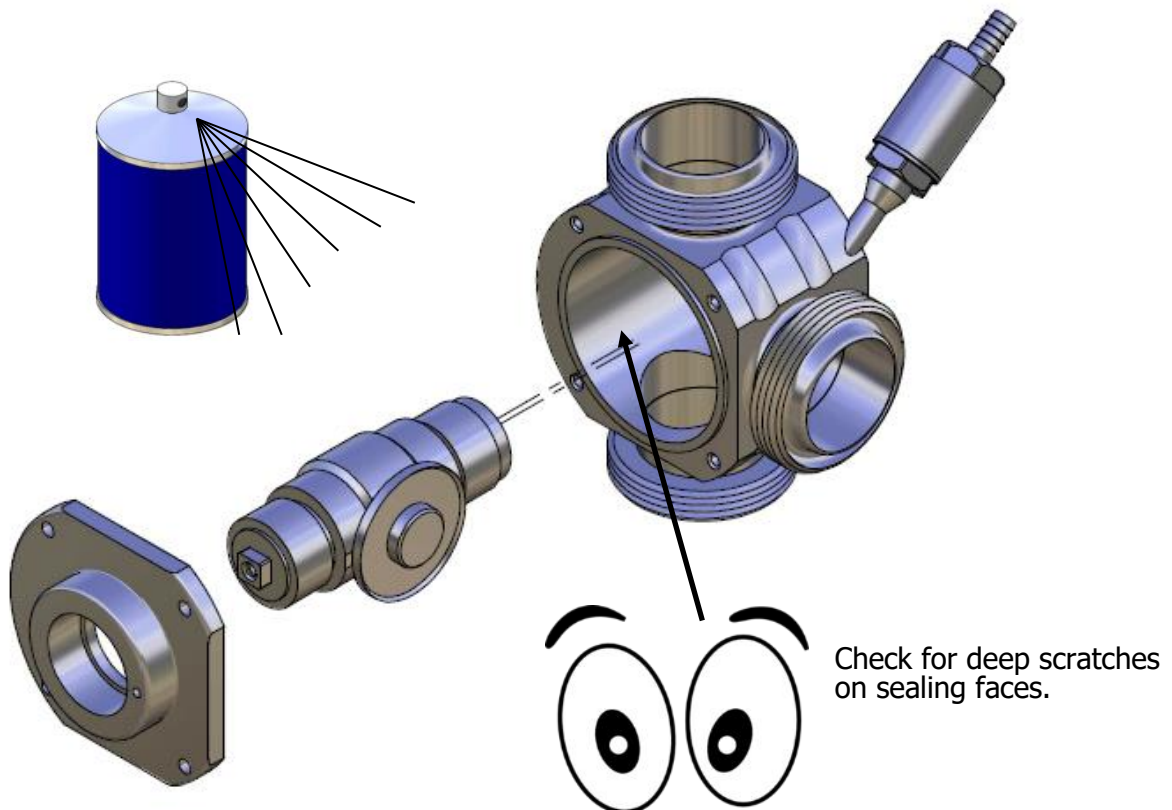

1. Lightly tap a new bush into the end cap using a soft punch.

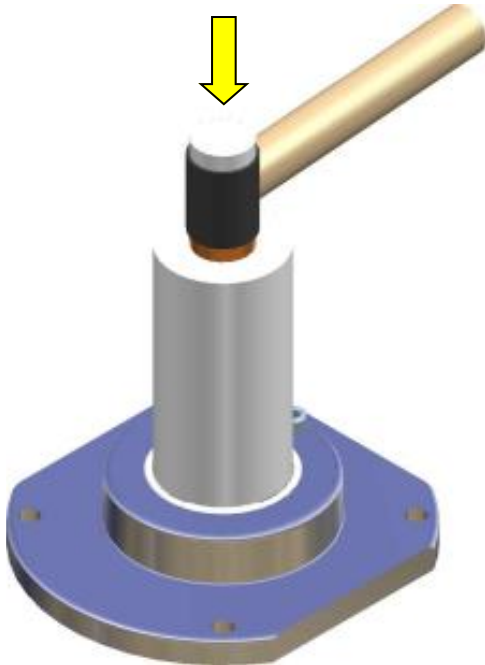

2. Lightly tap a new bush into the body using a soft punch.

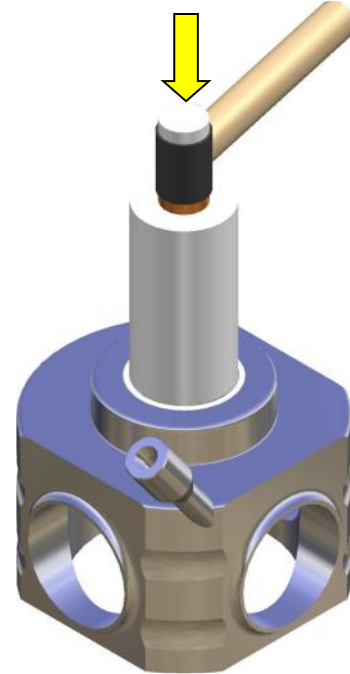

3. Measure the Internal Diameter of the bushes and ensure they are between 38.00 and 38.07mm. If the measurement is outside this tolerance a new bush must be installed.

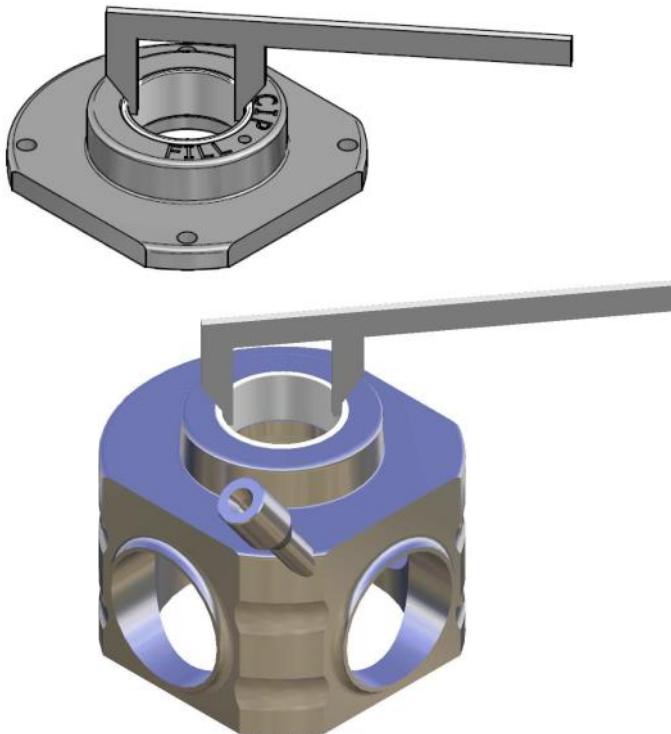

4. Apply food grade grease to the O-rings and install them on the spindle.

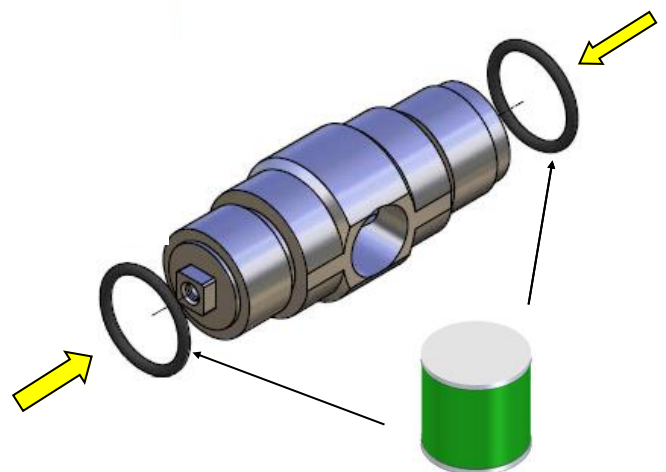

5. Apply food grade anti seize grease to the adjustment wedge and insert wedge into spindle until nut is flush with end of spindle.

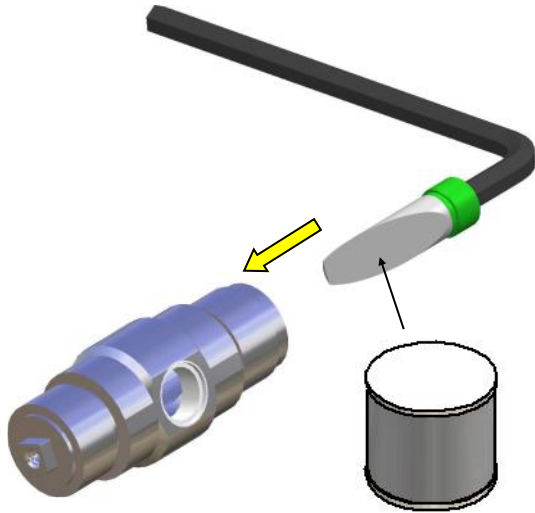

6. Push plug and plug support together by hand.

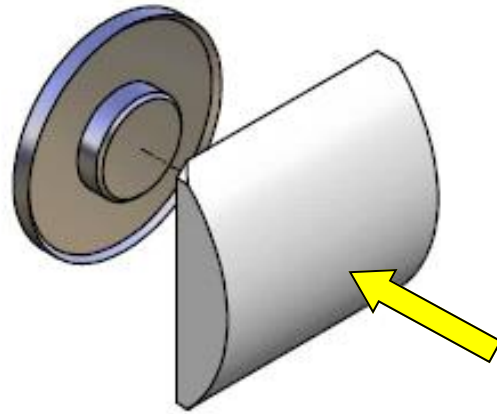

7. Place the plug in the body and using a press, push the plug so that it bites into the plug support.

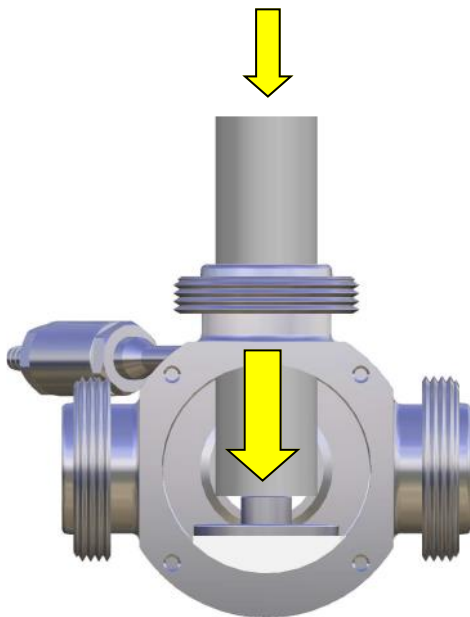

8. Place O-ring onto plug support and slide gland over.

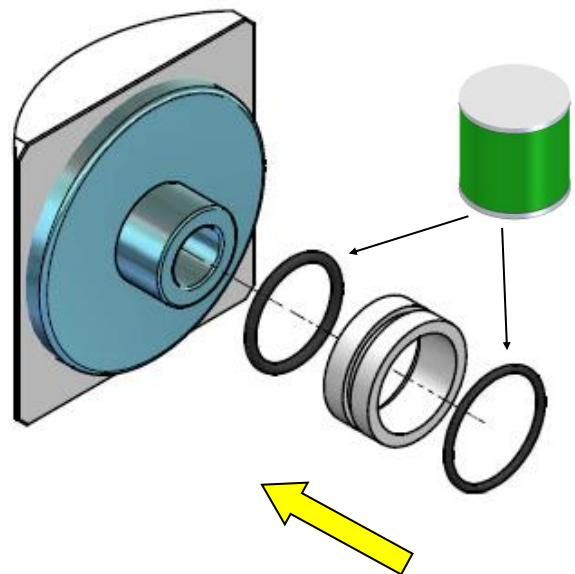

9. Slide Belleville washers over plug.

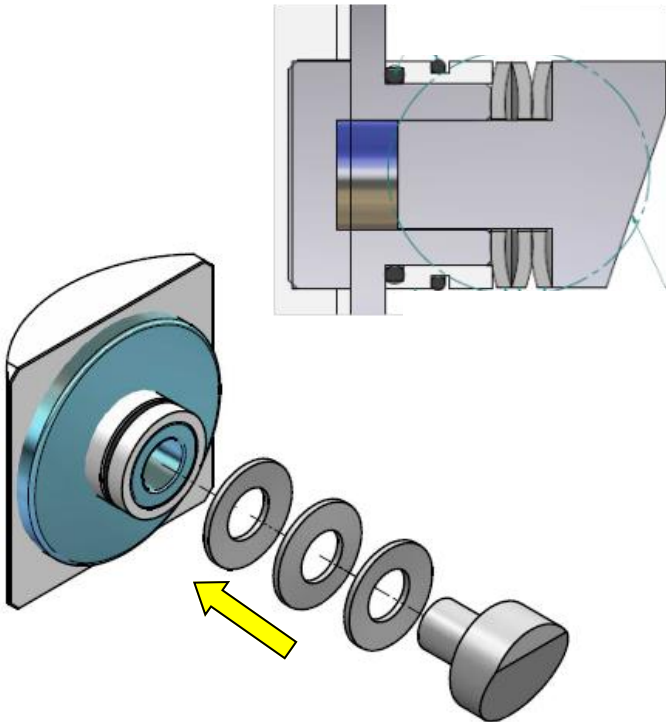

10. Install plug assembly into spindle. Ensure the taper is facing the adjustment wedge.

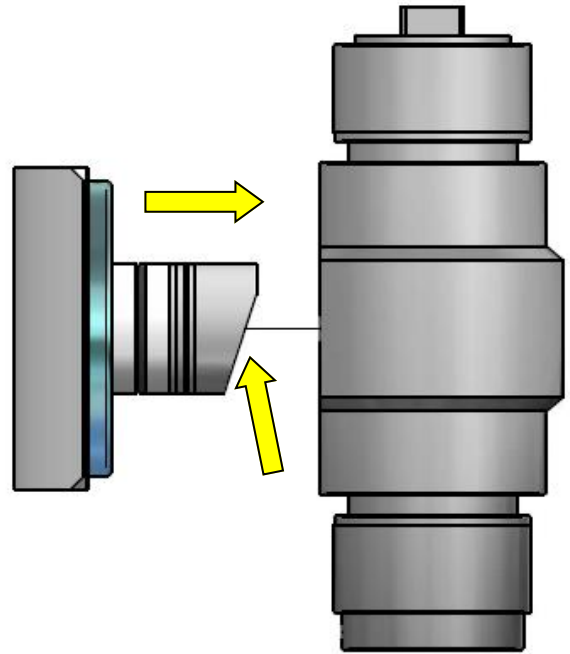

11. Grease O-ring with food grade grease and install into the end cap.

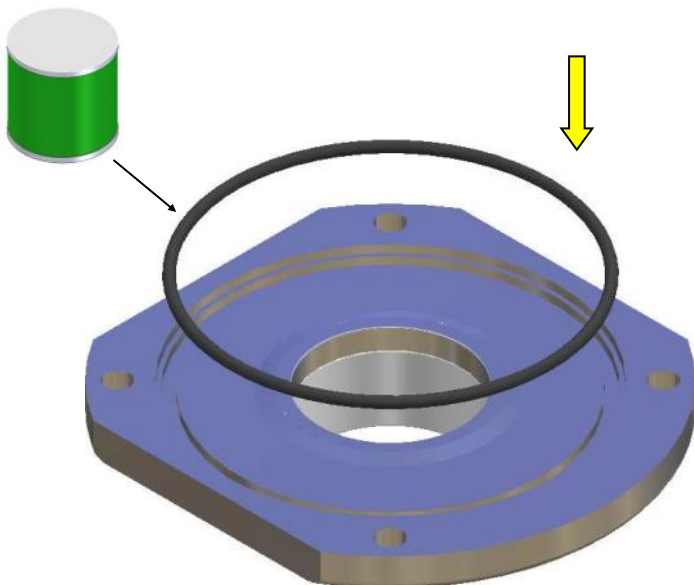

12. Slide spindle assembly into body, install wedge end first. It should click into place.

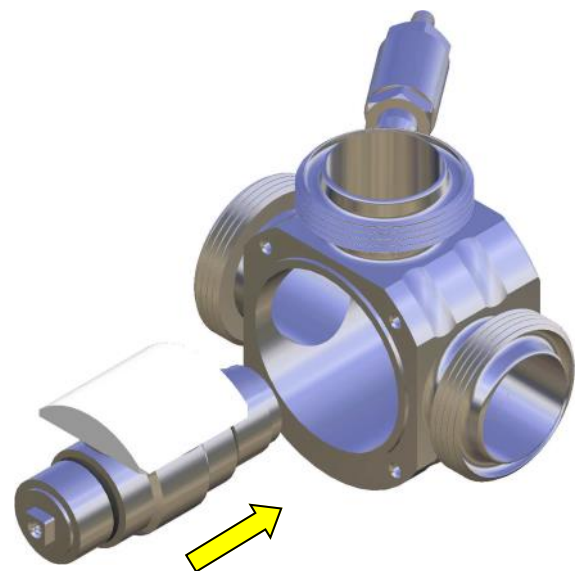

13. Install the end cap.

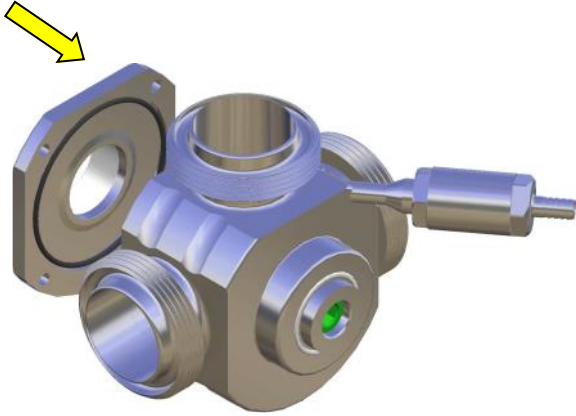

14. Apply anti seize to cap screws, install into body and tighten to 10 Nm.

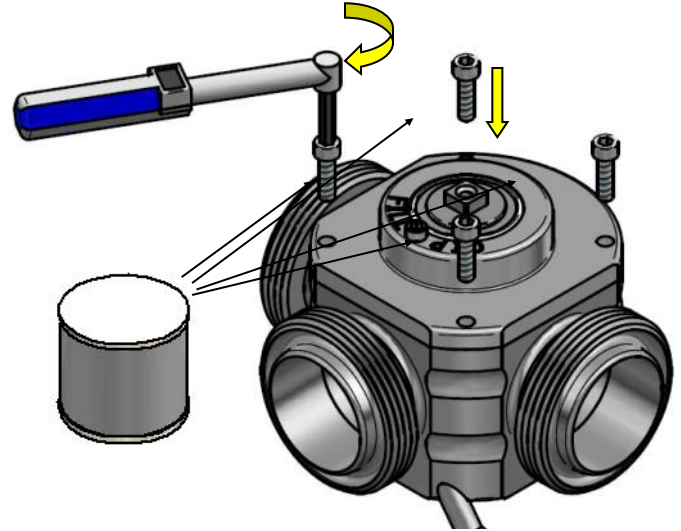

15. Re attach the handle. Torque to 12 Nm.

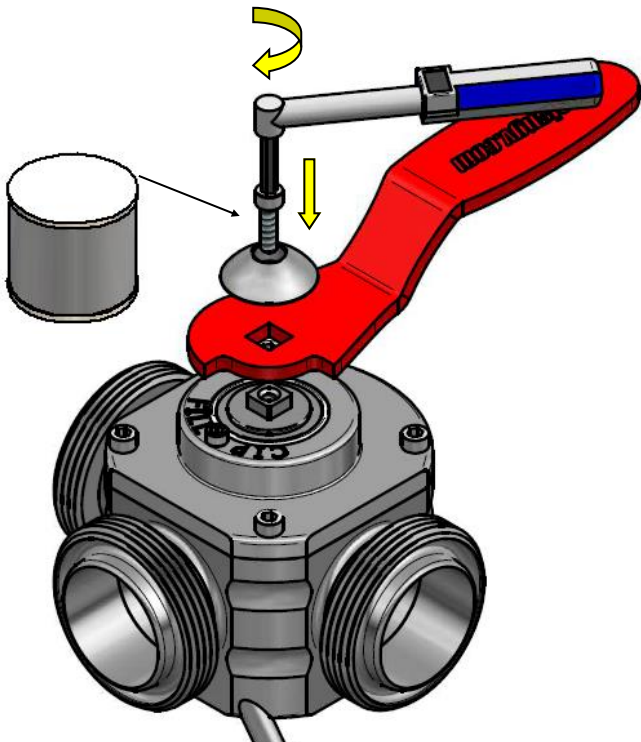

16. Torque the adjusting wedge to 9Nm.

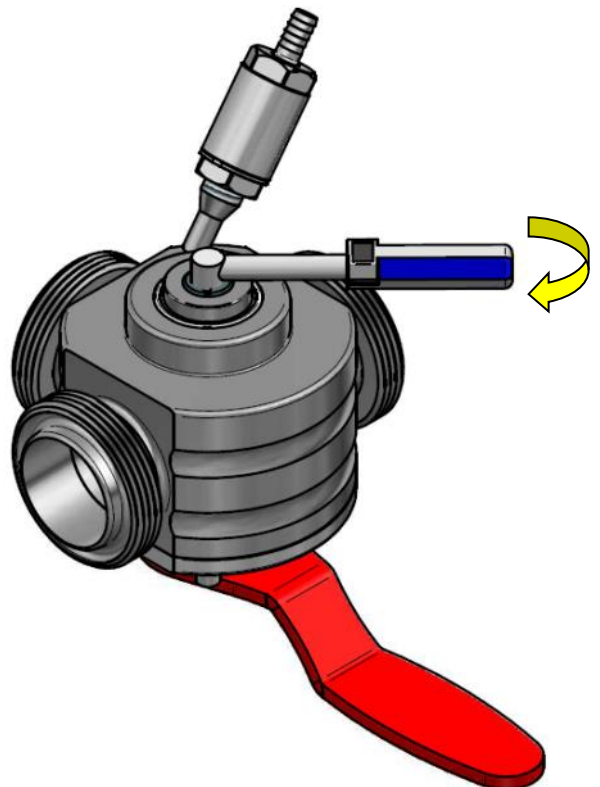

16. Tighten the adjustment wedge lock nut firmly into place.

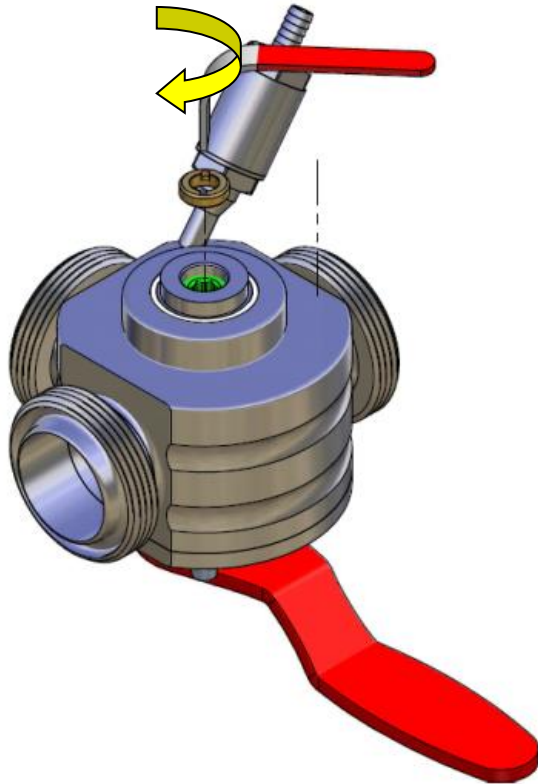

17. Servicing complete, follow installation instructions on page 3 for re-installation of product.

